

Wireless Indoor Repeater

General Information

The 2GIG[®] Wireless Indoor Repeater (2GIG-RPTR100-345) is a peripheral device that receives and recognizes messages from other 2GIG 345 MHz devices that are unable to directly communicate with the system, and “repeats” those messages to extend the range of these devices. The Repeater offers flexible signal transmission options, supporting both encrypted and non-encrypted modes, and is compatible with 2GIG wireless alarm systems.

The repeater is typically installed midway between the panel and the wireless devices to be repeated. When a transmission from a device is repeated, the repeater adds a bit to the message to indicate to the system that the message is not coming directly from the device. The repeater will not repeat already repeated messages.

The repeater is powered by an AC adapter and includes a rechargeable battery, providing 24-hour backup during local power outages. When switching between AC power and battery backup, the repeater automatically notifies the panel within 2 minutes. Additionally, it sends supervisory status updates approximately every 70 minutes.

The repeater is equipped with a status indicator LED visible from the front of the unit, and a learn button is located on the side of the unit.

Figure 1. Wireless Indoor Repeater Package Contents

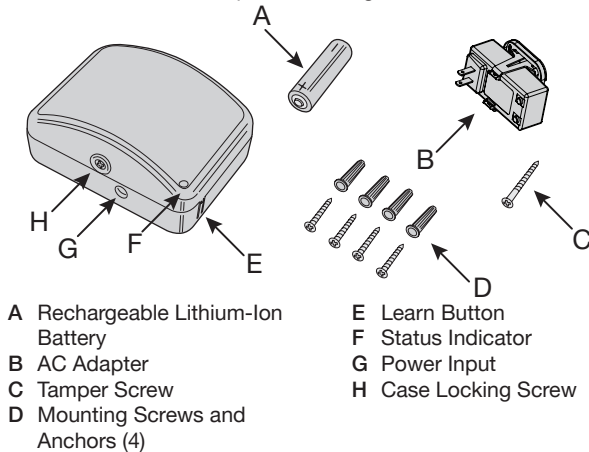

Installing the Battery

The rechargeable battery can be installed by opening the enclosure while the power is disconnected (see Figure 2).

WARNING: Observe battery polarity carefully. Align the battery with the polarity indicators on the circuit board. Incorrect installation may cause heat, explosion, or fire, leading to personal injury.

Encrypted/Unencrypted Mode Switch

The sensor is capable of transmitting signals in encrypted mode or unencrypted mode. The mode is set through a switch inside the sensor (see Figure 2).

By default, the factory setting is non-Encrypted mode. To change to Encryption mode, do the following:

1. With the front cover off, remove the battery from the slot.
2. Locate the dip switch directly above the battery compartment (see Figure 2) and note the switch setting: **ON** indicates *encrypted*, and **1** is *non-encrypted* mode. Move the switch position to **ON** for encrypted mode.
3. Wait at least 10 seconds, then reinsert battery and close the housing.
4. If the sensor was previously learned into a panel in a different mode, update the sensor class field and, if applicable, the sensor equipment code in sensor zone programming.

Installing the Repeater

Figure 2. Wireless Indoor Repeater Component and Feature Locations

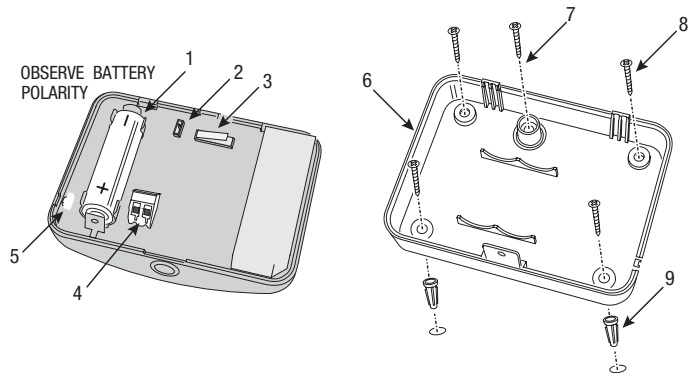

- | | |
|-------------------------------------|-------------------------|
| 1. Rechargeable Lithium-Ion Battery | 5. Learn Button |
| 2. Encryption Switch | 6. Repeater Base |
| 3. Tamper Switch | 7. Tamper Screw |
| 4. Power Input Connector | 8. Mounting Screws (4) |
| | 9. Mounting Anchors (4) |

Mounting Guidelines

Use these guidelines when installing the wireless indoor repeater:

- **Mount Repeaters within 100 ft (30 m) of the Control Panel.** Although the transmitter may have a range of 350 ft (106 m) in open air, the repeater location can have a significant effect on range. In open/unobstructed spaces, the transmitter range may be greater. In adverse wireless conditions, changing the repeater orientation can improve performance.
- **Mount Repeaters as high as possible.** Mounting the repeater high off the ground helps receiver sensitivity.
- **Do Not Expose Repeaters to Moisture or Extreme Temperature.** It is best to mount repeaters in a dry location where the operating temperature does not exceed 32° to 120° F (0° to 49° C).
- **Keep Repeaters Away from Metal/Metallic Surfaces.** To keep the repeater away from metal or metallic surfaces (for example, foil wallpaper), it is recommended that you use spacers (not included). You should also avoid mounting sensors in areas where there is a large quantity of metal or electrical wiring (for example, near a furnace or in a utility room).

To install the wireless repeater:

1. Open the repeater case.
2. Attach the base to the desired wall location with the four (4) Phillips head screws and anchors supplied (see Figure 2).
3. Install the tamper screw (see Figure 2). With the tamper screw installed, removing the case from the wall triggers tamper.

NOTE: For the tamper to work correctly, the tamper screw must be installed into a wall stud. Do not use a wall anchor.
4. Install the battery. **Observe battery polarity.**
5. Connect the 2-conductor wire to the power supply and to the terminal connector on the circuit board. Make sure the wire passes through the grommet and hole on the repeater base before connecting to the terminal.
6. Attach the repeater cover to the base and secure the assembly with the Phillips head case locking screw.

7. Plug the AC adapter into an AC outlet. The status indicator will emit a steady green light.

NOTE: Do not connect the AC adapter to an AC outlet that is controlled by a switch.

8. Once the repeater is powered up, it begins repeating all unrepeat 345 MHz 2GIG transmissions.

WARNING: This device is not designed to repeat signals from life safety devices such as Smoke or CO detectors.

ATTENTION : Cet appareil est conçu pour ne pas répéter les signaux provenant des dispositifs de sécurité de la vie tels que la fumée ou les détecteurs de CO.

Status Indications

The status indicator shows the repeater status as follows:

- **Steady Green:** The repeater is AC powered, and the backup battery is good.
- **Solid Red:** Tamper or AC power failure.
- **Slow Flashing Red:** Low battery.
- **Fast Flashing Red:** Jammed.
- **Blink off:** Transmission received.

Specifications

| | |
|-----------------------------------|---|
| Supervisory Interval | 70 minutes |
| Overall Size | 102 x 76 x 46mm (4.0" x 3.0" x 1.8") |
| Material | High-impact ABS plastic |
| Color | White |
| Weight (without battery) | 125 g (4.4 oz.) |
| Installation Type | Wall mounted |
| Operating Frequency | 345 MHz |
| Operating Temperature Limits | -10° C to 55° C (14° F to 131° F) |
| Relative Humidity | 5 to 85% non-condensing |
| Power Type | Remotely powered by AC adapter, with internal battery backup |
| AC Adapter Nominal Input Voltage | 100–240 VAC 50/60 Hz |
| AC Adapter Nominal Output Voltage | 14 VDC |
| Maximum Power Consumption | 3 W |
| Idle Current | 40mA |
| Operating Current (repeating) | 75mA |
| Storage Device Capacity | 800 mAh (1) 3.7V 800 mAh 14500 Type Li-ion battery (not to be replaced) |
| Equipment Code | 2067 (encrypted), 1067 (non-encrypted) |
| Panel Programming Sensor Loop | Loop 1 |

Regulatory Information

We, Nice North America LLC of 5919 Sea Otter Place STE 100, Carlsbad, CA 92010, declare under our sole responsibility that the device, 2GIG-RPTR100-345 complies with Part 15 of the FCC rules.

FCC & IC Notice

This device complies with Part 15 of the FCC Rules and Industry Canada license exempt standard(s). Operation is subject to the following two conditions:

- (1) This device may not cause harmful interference, and
- (2) This device must accept any interference received, including interference received that may cause undesired operation.

Le présent appareil est conforme aux CNR d'Industrie Canada applicables aux appareils radio exempts de licence. L'exploitation est autorisée aux deux conditions suivantes:

- (1) l'appareil ne doit pas produire de brouillage, et
- (2) l'utilisateur de l'appareil doit accepter tout brouillage radioélectrique subi, même si le brouillage est susceptible d'en compromettre le fonctionnement.

This Class B digital apparatus complies with Canadian ICES-003

Cet appareil numérique de la classe B est conforme à la norme NMB-003 du Canada.

This equipment has been tested and found to comply with the limits for a Class B digital device, pursuant to Part 15 of the FCC Rules. These limits are designed to provide reasonable protection against harmful interference in a residential installation.

This equipment generates, uses, and can radiate radio frequency energy and, if not installed and used in accordance with the instructions may cause harmful interference to radio communications. However, there is no guarantee that interference will not occur in a particular installation. If this equipment does cause harmful interference to radio or television reception, which can be determined by turning the equipment off and on, the user is encouraged to try to correct the interference by one or more of the following measures:

- Reorient or relocate the receiving antenna.
- Increase the separation between the equipment and receiver
- Connect the equipment into an outlet on a circuit different from that to which the receiver is connected
- Consult the dealer or an experienced radio/TV technician to help.



Federal Communication Commission (FCC) Radiation Exposure Statement

When using the product, maintain a distance of 20cm from the body to ensure compliance with RF exposure requirements.

IC RF exposure Radiation Exposure Statement:

This equipment complies with IC radiation exposure limits set forth for an uncontrolled environment. This equipment should be installed and operated with minimum distance 20cm between the radiator & your body.

Déclaration d'exposition aux radiations:

Cet équipement est conforme aux limites d'exposition aux rayonnements IC établies pour un environnement non contrôlé. Cet équipement doit être installé et utilisé avec un minimum de 20 cm de distance entre la source de rayonnement et votre corps.

Warning

Changes or modifications not expressly approved by the manufacturer could void the user's authority to operate the equipment.

* For more warranty and compliance information, visit our website at www.2gig.com

Limited Warranty

This Nice North America LLC product is warranted against defects in material and workmanship for two (2) years. This warranty extends only to wholesale customers who buy direct from Nice North America LLC or through Nice North America LLC's normal distribution channels. Nice North America LLC does not warrant this product to consumers. Consumers should inquire from their selling dealer as to the nature of the dealer's warranty, if any.

There are no obligations or liabilities on the part of Nice North America LLC for consequential damages arising out of or in connection with use or performance of this product or other indirect damages with respect to loss of property, revenue, or profit, or cost of removal, installation, or reinstallation. All implied warranties for functionality, are valid only until the warranty expires. This Nice North America LLC Warranty is in lieu of all other warranties expressed or implied.



Customer Service

760-438-7000
Monday – Friday, 5 a.m. – 4:30 p.m. PST
Saturday, 7 a.m. – 3:30 p.m. PST

www.2gig.com

Nice North America LLC

5919 Sea Otter Place, Suite 100
Carlsbad, CA 92010



©2025 Nice North America LLC. 2GIG is a registered trademark of Nice North America LLC. All rights reserved. 10034956 Rev-A